

## SG8-M



- 8\*10/100/1000Mbps RJ45 ports.
- IEEE802.3, IEEE802.3u, IEEE802.3ab, IEEE802.3x.
- Three operating modes (Default, VLAN, CCTV).
- Excellent performance of anti-interference, 6KV surge immunity & 8KV ESD protection.
- Plug and play.



## Overview

The unmanaged gigabit switch is specially designed for HD video surveillance and network engineering, providing 8\*10/100/1000Mbps RJ45 ports. The switch supports three operating modes (Default, VLAN, CCTV). The switch supports 8KV ESD protection, which can protect the device from the damage by direct lightning and keep the stable transmission. The SG8-M is widely used in security video monitoring and network engineering etc.

## Application

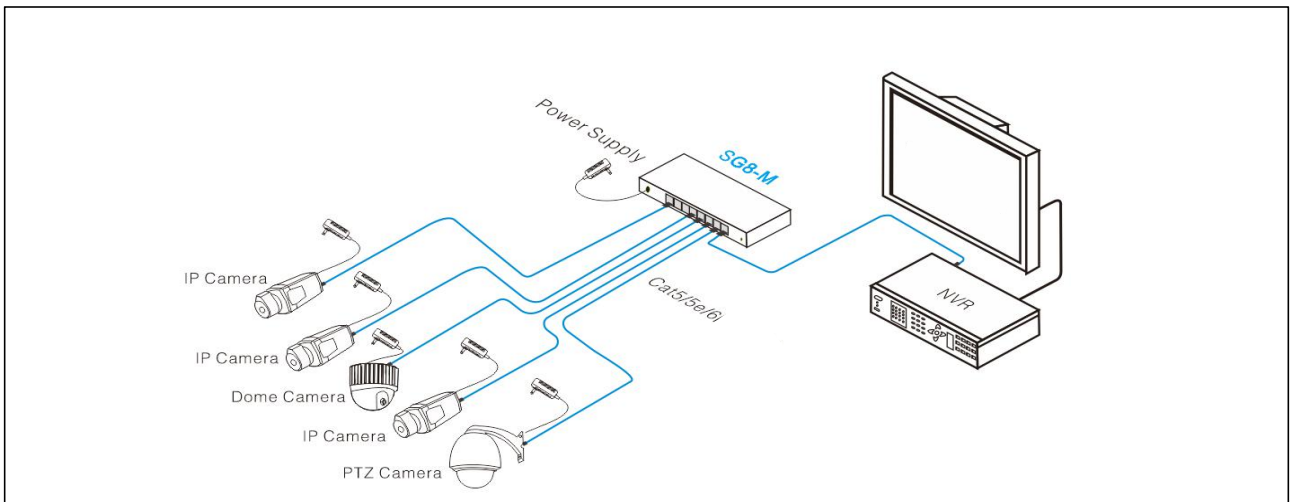

## Physical Features

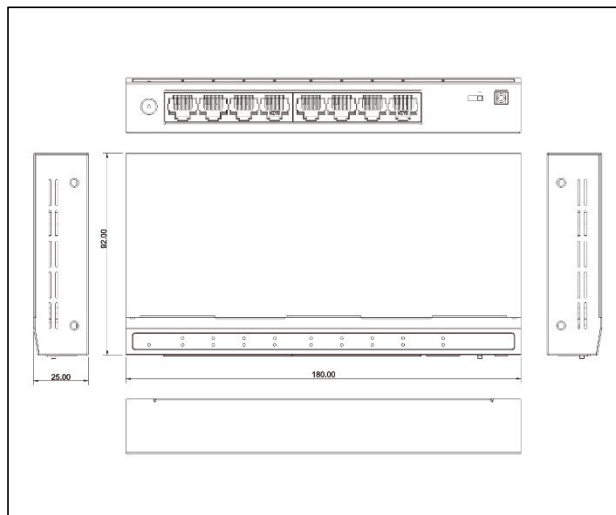

## Interface drawing

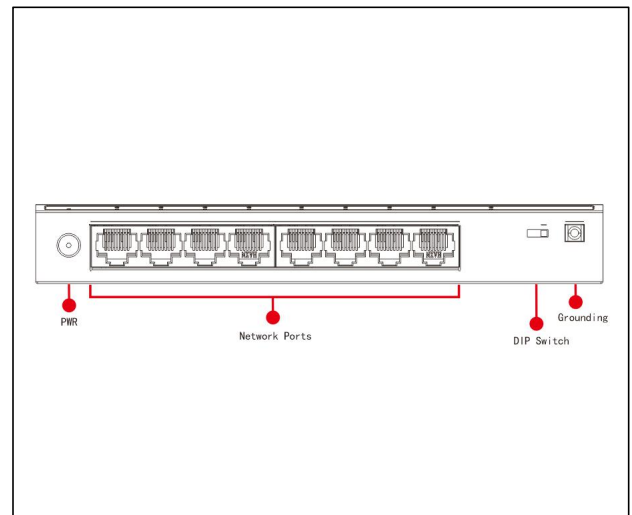

Specification

Model	SG8-M
Downlink Ports	8*10/100/1000Base-T ports
Network Standard	IEEE802.3, IEEE802.3u, IEEE802.3ab, IEEE802.3X
Switch Capacity	16Gbps
Throughput	11.584Mpps
Switch Processing Scheme	Store and Forward
Memory Buffer	2.5Mbps
MAC Table	1K
Jumbo Frame	9KB
One-key Smart	Default: All port can be communicated freely.
	VLAN: Port 1-6 are isolated respectively, but can communicate with Port 7-8.
	CCTV: The rates of Port 1-8 are limited to 10M, but with transmission distance of 250 meters.
Lightning Protection	6KV Execute: IEC61000-4-5
ESD	6KV Contact discharge 16KV Air discharge Execute: IEC61000-4-2
Power Supply	Desktop power adapter, DC 2.1 Jacket
Power Input	AC: 100~240V- 50~60Hz
Power Output	DC: 5V- 1.0A
Surge on Power Supply	Common mode - 6KV, Difference mode - 4KV
Power Consumption	<5W
Work Temperature	-10°C~50°C
Storage Temperature	-40°C~85°C
Humidity (Non-condensing)	5%-95% (Non-condensing)
Dimension (L*W*H)	180mm*92mm*25mm
Weight	1kg
Certification	CE, FCC, ROHS

Packing List

Item	Quantity
SG8-M	1
Power Adapter	1
User Manual	1

Related Product

Name	Model
5-Port 100M PoE Switch	SF5
5-Port Gigabit PoE Switch	SG5-M
8-Port 100M PoE Switch	SF8